

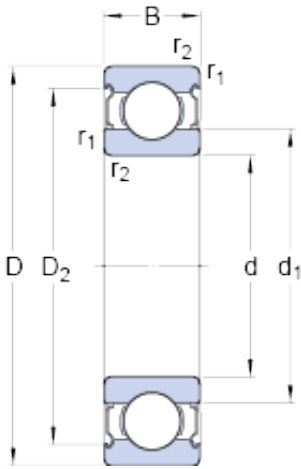

Changzhou Suma Precision Machinery Co...



E2.6312-2Z Bearing 2D drawings and 3D CAD models

60 mm x 130 mm x 31 mm SKF E2.6312-2Z
deep groove ball bearings

Bearing No. E2.6312-2Z

Size	130x60x31 mm
Bore Diameter	130 mm
Outer Diameter	60 mm
Width	31 mm
d	60 mm
D	130 mm
B	31 mm
d ₁	81.86 mm
D ₂	112.2 mm
r _{1,2} - min.	2.1 mm
d _a - min.	72 mm
d _a - max.	81.8 mm
D _a - max.	118 mm
r _a - max.	2 mm
Basic dynamic load rating - C	81.9 kN
Basic static load rating - C ₀	52 kN
Fatigue load limit - P _u	2.2 kN
Reference speed	12000 r/min
Limiting speed	6700 r/min
Calculation factor - k _r	0.03
Calculation factor - f ₀	13