

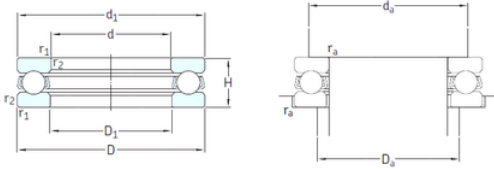

SKF 51113 thrust ball bearings



Bearing No. 51113

51113 Bearing 2D drawings and 3D CAD models

Size	65x90x18 mm
Bore Diameter	65 mm
Outer Diameter	90 mm
Width	18 mm
d	65 mm
D	90 mm
H	18 mm
d1	90 mm
r1 min.	1 mm
r2 min.	1 mm
D1	67 mm
da min.	80 mm
Da max.	75 mm
ra max.	1 mm
Weight	0,33 Kg
Basic dynamic load rating (C)	37,7 kN
Basic static load rating (C0)	108 kN
Fatigue load limit (Pu)	4
Reference speed	3400 r/min
Limiting speed	4800 r/min
Category	Thrust Ball Bearing
Inventory	0.0
Manufacturer Name	SKF
Minimum Buy Quantity	N/A
Weight / Kilogram	0.341
EAN	7316576677519



Changzhou Suma Precision Machinery Co...

Product Group	B00308
Rolling Element	Ball Bearing
Thrust Bearing	Yes
Single or Double Direction	Single Direction
Banded	No
Cage Material	Steel
Precision Class	ABEC 1 ISO P0
Component Description	Roller Assembly Plus Raceways
Other Features	Single Row
Long Description	65MM Bore 1; 67MM Bore 2; 90MM Outside Diameter; 18MM Height; Ball Bearing; Single Direction; Not Banded; Steel Cage; ABEC 1 ISO P0 Precision
Inch - Metric	Metric
Category	Thrust Ball Bearings
UNSPSC	31171507
Harmonized Tariff Code	8482.10.50.08
Noun	Bearing
Keyword String	Ball Thrust
Manufacturer URL	http://www.skf.com
Manufacturer Item Number	51113
Weight / LBS	0.75
Height	0.709 Inch 18 Millimeter
Bore 1	2.559 Inch 65 Millimeter
Overall Height with Aligning Washer	0 Inch 0 Millimeter
Outside Diameter	3.543 Inch 90 Millimeter
Bore 2	2.638 Inch 67 Millimeter
bore diameter:	65 mm
static load capacity:	108 kN
outside diameter:	90 mm



Changzhou Suma Precision Machinery Co...

dynamic load capacity:	37.7 kN
overall width:	18 mm
maximum rpm:	4800 RPM
thrust bearing type:	Single-Direction
cage material:	Steel
outside diameter design:	Straight
fillet radius:	1 mm
separable or banded:	Separable
series:	511
precision rating:	ABEC 1 (ISO Class Normal)
d_1	90 mm
D_1	67 mm
$r_{1,2}$ min.	1 mm
d_a min.	80 mm
D_a max.	75 mm
r_a max.	1 mm
Basic dynamic load rating C	37.7 kN
Basic static load rating C_0	108 kN
Fatigue load limit P_u	4 kN
Minimum load factor A	0.06
Mass bearing (including seat washer where applicable)	0.33 kg