

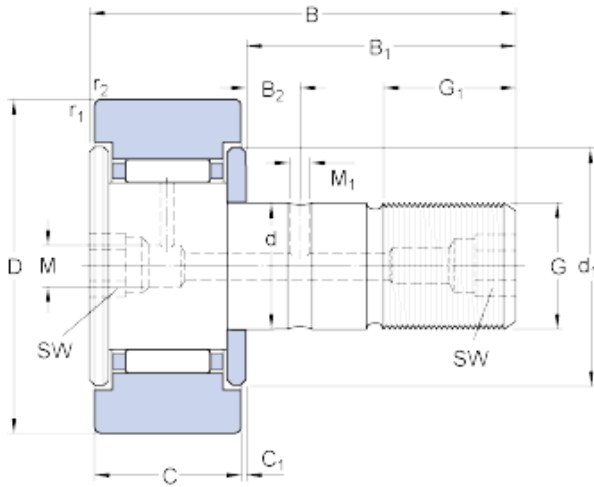

Changzhou Suma Precision Machinery Co...



20 mm x 52 mm x 66 mm SKF KR 52 XB cylindrical roller bearings

Bearing No. KR 52 XB

KR 52 XB Bearing 2D drawings and 3D CAD models

Size	20x52x66 mm
Bore Diameter	20 mm
Outer Diameter	52 mm
Width	66 mm
D	52 mm
d	20 mm
B	66 mm
C	24 mm
B ₁	40.5 mm
B ₂	9 mm
C ₁	0.8 mm
d ₁	36.5 mm
G	M 20x1.5
G ₁	21 mm
M	6 mm
M ₁	4 mm
SW	10 mm
r _{1,2} - min.	1 mm
Basic dynamic load rating - C	15.7 kN
Basic static load rating - C ₀	27 kN
Fatigue load limit - P _u	3.2 kN
Maximum dynamic radial loads - F _r	36 kN
Maximum static radial loads	51 kN



Changzhou Suma Precision Machinery Co...

- F_{0r}	
Limiting speed	3000 r/min
Mass support roller	0.46 kg
Recommended tightening torque	120 N · m
Grease fitting	NIP A2x7.5
Hexagonal nut	M 20x1.5
B_1	40.5 mm
B_2	9 mm
C_1	0.8 mm
d_1	36.5 mm
G_1	21 mm
M_1	4 mm
$r_{1,2}$ min.	1 mm
Basic dynamic load rating C	15.7 kN
Basic static load rating C_0	27 kN
Fatigue load limit P_u	3.2 kN
Maximum dynamic radial loads F_r max.	36 kN
Maximum static radial loads F_{0r} max.	51 kN
Mass cam follower	0.46 kg
Lubrication adapter	AP 10